



# Installation and maintenance instructions

## Arcade vault

Designation and commercial reference: Arcade Vault

DOP: VAR

**Warning:**

This notice cannot constitute a contractual document; the manufacturer reserves the right to make without notice any modification he deems useful.



Page 1 on 14	Ref: NIE-VOUT Arcade vault Note installation and maintenance Updated: 15/09/2022	SKYDOME Factory Entre-deux-Villes 02270 Sounds-and-Ronchères Phone : 03 23 21 79 90	
-----------------	---	--	---



## Installation and maintenance instructions

Arcade vault

### Summary

1. Foreword	Page 3
2. Tools to plan	Page 3
3. Editing	Page 3
3.1 Eardrum placement – plate 1	Page 3
3.2 Laying Shoreline Profiles – Plate 2	Page 4
3.3 Installation of hoops – Plate 3	Page 4
3.4 Installation of reinforcements 1200 joules – Plate 4	Page 4
3.5 Pose of the plates PCA vault part – Plate 5	Page 4
3.6 Installation of joint covers – Boards 6	Page 5
3.7 Installation of EPDM seals – Plate 7	Page 5

### 1. Foreword

Page 2 on 14	Ref: NIE-VOUT Arcade vault Note installation and maintenance Updated: 15/09/2022	SKYDOME Factory Entre-deux-Villes 02270 Sounds-and-Ronchères Phone : 03 23 21 79 90	
-----------------	---	--	---



## Installation and maintenance instructions

Arcade vault

Before assembling the Arcade vault, it is essential to check the following elements:

- **Dimensioning of upstand**  
The dimensions, angles, thickness of the costières must be in accordance with the plan(s) transmitted by SKYDOME to the order.
- **Squaring of the upstand**  
The tolerance at right angles of the costières shall not exceed 20 mm.
- **Hopper dimensions**  
The width (rope) and length of the hopper (internal costing dimensions) must be in accordance with + or – 10 mm to the plane(s) transmitted by SKYDOME to the order.

***Warning: any deviation must be rectified before installation. SKYDOME reserves the right to withdraw its warranty otherwise.***

### 2. Tools to be planned

- Electric screwdriver-unscrewdriver with socket n° 10-13
- Flat screwdriver
- Phillips screwdriver
- Allen Key No. 6 – (a complete set is recommended)
- Flat key n° 10-13-19
- Pipe wrench No. 10-13
- Universal clamp
- Cutter
- Tape measure
- Hacksaw or shear

### 3. Assembly

#### 3.1 Eardrum placement – Plate 1

- Position the first eardrum on the butt costière ensuring its verticality and fix it by 3 self-drilling screws 6.3 x 25 distributed over the length of the eardrum.
- Align the inside of the butt with the 15 mm return of the eardrum.

Page 3 on 14	Ref: NIE-VOUT Arcade vault Note installation and maintenance Updated: 15/09/2022	SKYDOME Factory Entre-deux-Villes 02270 Sounds-and-Ronchères Phone : 03 23 21 79 90	
-----------------	---	--	---



## Installation and maintenance instructions

Arcade vault

### 3.2 Pose shoreline profiles – Plate 2

- Position and fix the edge profiles on the rib by 3 self-drilling screws (3 screws per profile).
- Respect the numbering, meaning and order of these profiles.
- Refer to the document "Distribution of aluminum profiles".

### 3.3 Installing hoops – Plate 3

- Position each roll bar to the right of the factory holes of the edge profiles and fix it by 2 self-drilling screws 6.3 x 25 at each end.
- After the installation of all the arches, fix the second tympanum at the end of the vault in the same way as the first.
- Check the values of the centre distance of the hoops by referring to the document "Distribution of aluminum profiles".

### 3.4 Installation of reinforcements 1200 joules – Plate 4

- Fix the reinforcements 1200 joules (U 20/20) in front of each roll bar to the right of the factory holes with 2 Sheet Screws 6.3x19 and waterproof washers.

The length of the reinforcements is equal to a multiple of the centre distance of the hoops, namely:

- 3 times the center distance (max)
- 2 times the center distance
- 1 time the center distance

The number and distribution of reinforcements are given by the factory holes of the hoops. Refer to the document "Distribution of aluminum profiles".

**➔ Installation tip: The 1200 joule reinforcements can be fixed on the hoops before they are installed**

### 3.5 Installation of PCA plates vault part – Boards s 5

- Place the plates between each arch, the face printed towards the outside of the building respecting a20 mm lateral foliage and an interlocking foliage of about 25 mm in the edge profiles. The Arcadef leaf plates will be installed after the installation of the pneumatic cylinders and consoles.

**Caution: Do not damage the adhesive tape sealing the cells: replace it if necessary.**

Page 4 on 14	Ref: NIE-VOUT Arcade vault Note installation and maintenance Updated: 15/09/2022	SKYDOME Factory Entre-deux-Villes 02270 Sounds-and-Ronchères Phone : 03 23 21 79 90	
-----------------	---	--	---



## Installation and maintenance instructions

Arcade vault

### 3.6 Installation of joint covers – Plate 6

- Position the joint covers above the hoops, fit them into the edge profiles in the lower part.
- Stretch them at each end with a TH 8x40 screw by distributing the tightening.
- Place the stainless-steel sheet screws TH 6.3, tighten moderately.

➔ **Installation tip:** *The installation of the joint covers is done at the progress of the assembly of the PCA plates.*

### 3.7 Installation of EPDM seals – Boards s 7

- Cut and clip the JC joint on the joint covers at the arch end and the edge joint (JR) at the bottom between the joint covers.
- Respect the direction of pose.

Page 5 on 14	Ref: NIE-VOUT Arcade vault Note installation and maintenance Updated: 15/09/2022	SKYDOME Factory Entre-deux-Villes 02270 Sounds-and-Ronchères Phone : 03 23 21 79 90	
-----------------	---	--	---

## Installation and maintenance instructions

Arcade vault

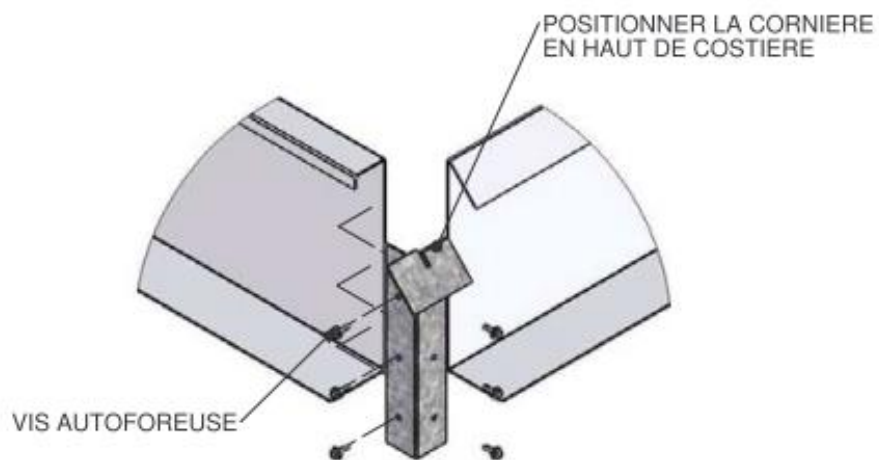
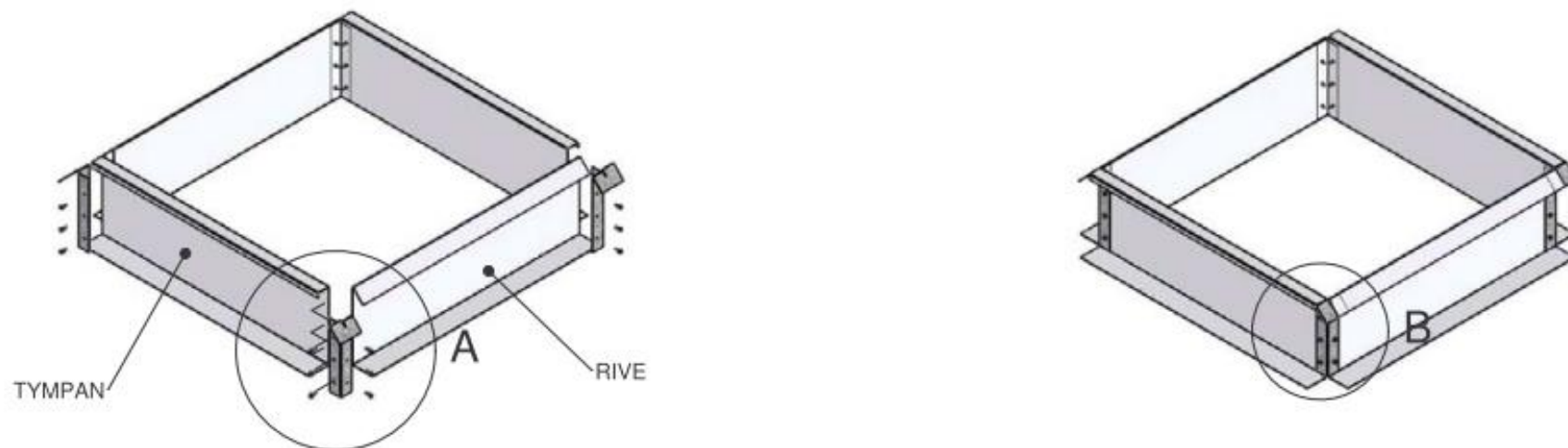

DÉTAIL A  
ECHELLE 1 : 8

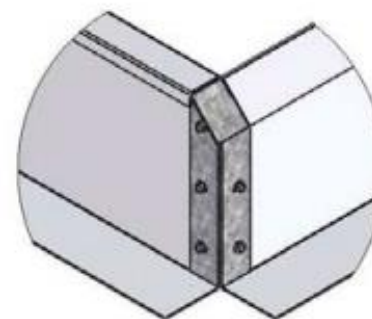

DÉTAIL B  
ECHELLE 1 : 8

		DEPARTEMENT ECLAIREMENT ZENITHAL ET DESENFUMAGE INCENDIE D'AXTER Entre deux Villes 02270 SONS-ET-RONCHERES		Tél. : +33 (0)3 23 21 79 90 Fax. : +33 (0)3 23 20 51 18 Email : info@skydome-axt.com	
Numéro de Plan: <b>W1633</b>	Indice du Plan: <b>0</b>	Echelle du plan: <b>1:20</b>	Feuille : <b>1 / 1</b>		
NOTICE COSTIERE ASSEMBLEE PAR CORNIERE POUR VOUTE DE CORDE 1 ML LONGUEUR 1 ML			Créé ou Modifié Par : <b>G.RICHIER</b>	16/02/11	
			Validé Par : <b>O. COURTONNE</b>	16/02/11	

# Installation and maintenance instructions

Arcade vault

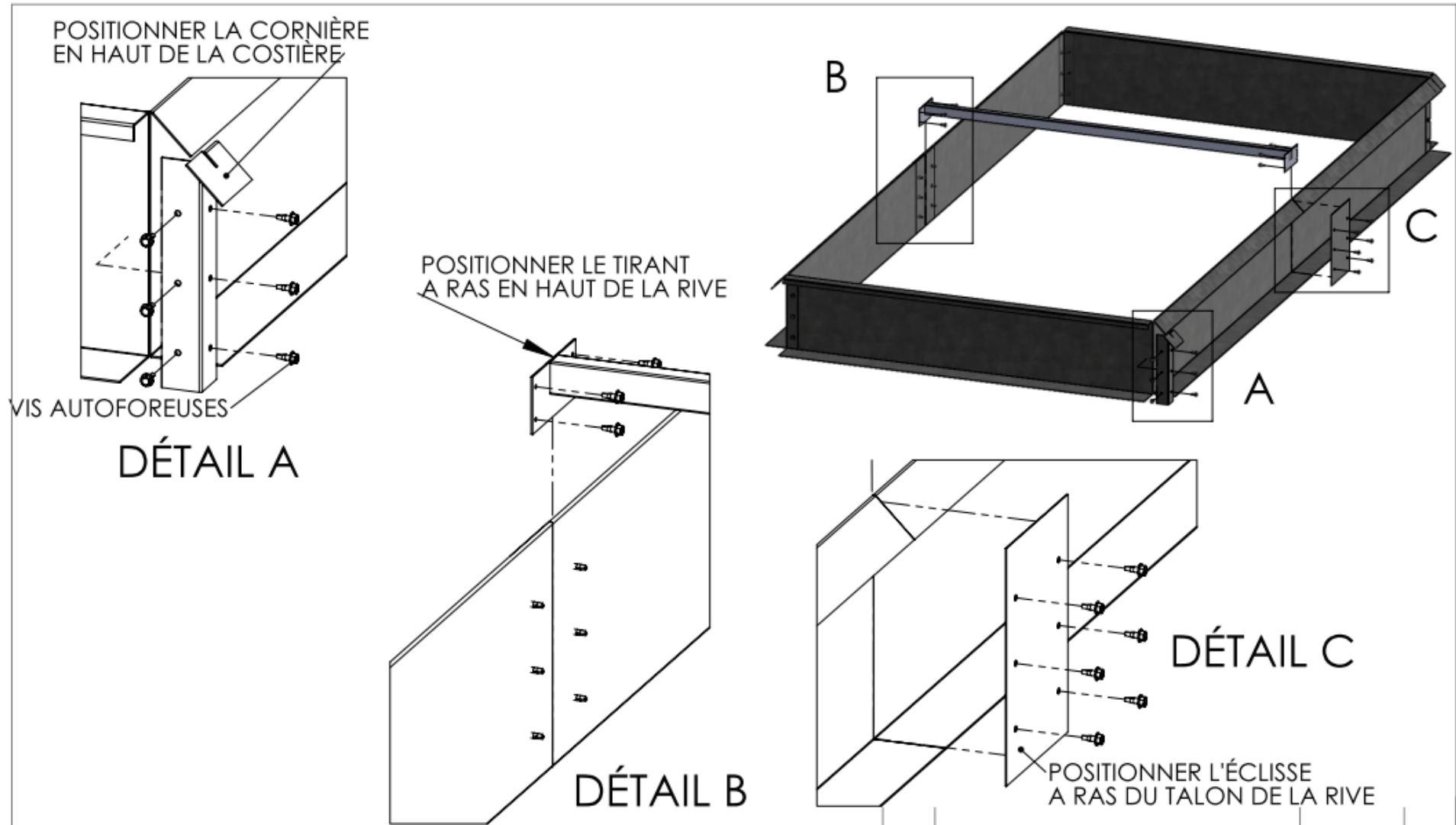

Usine de :	Tolérance suivant :	Indice	Nature des modifications	Date	Par
 FORMAT A4 : 1/1	N° de plan : <b>NOTICE ASSEMBLAGE</b>				Matiere :
	N° de pièce : <b>NOTICE ASSEMBLAGE</b>				
	DEPARTEMENT ECLAIREMENT ZENITHAL ET DESENFUMAGE INCENDIE D'AXTER Entre deux Villes 02270 SONS-ET-RONCHERES Tél. : +33 (0)3 23 21 79 90 Fax : +33 (0)3 23 20 51 18 Email : info@skydome.eu				
					Par : le :

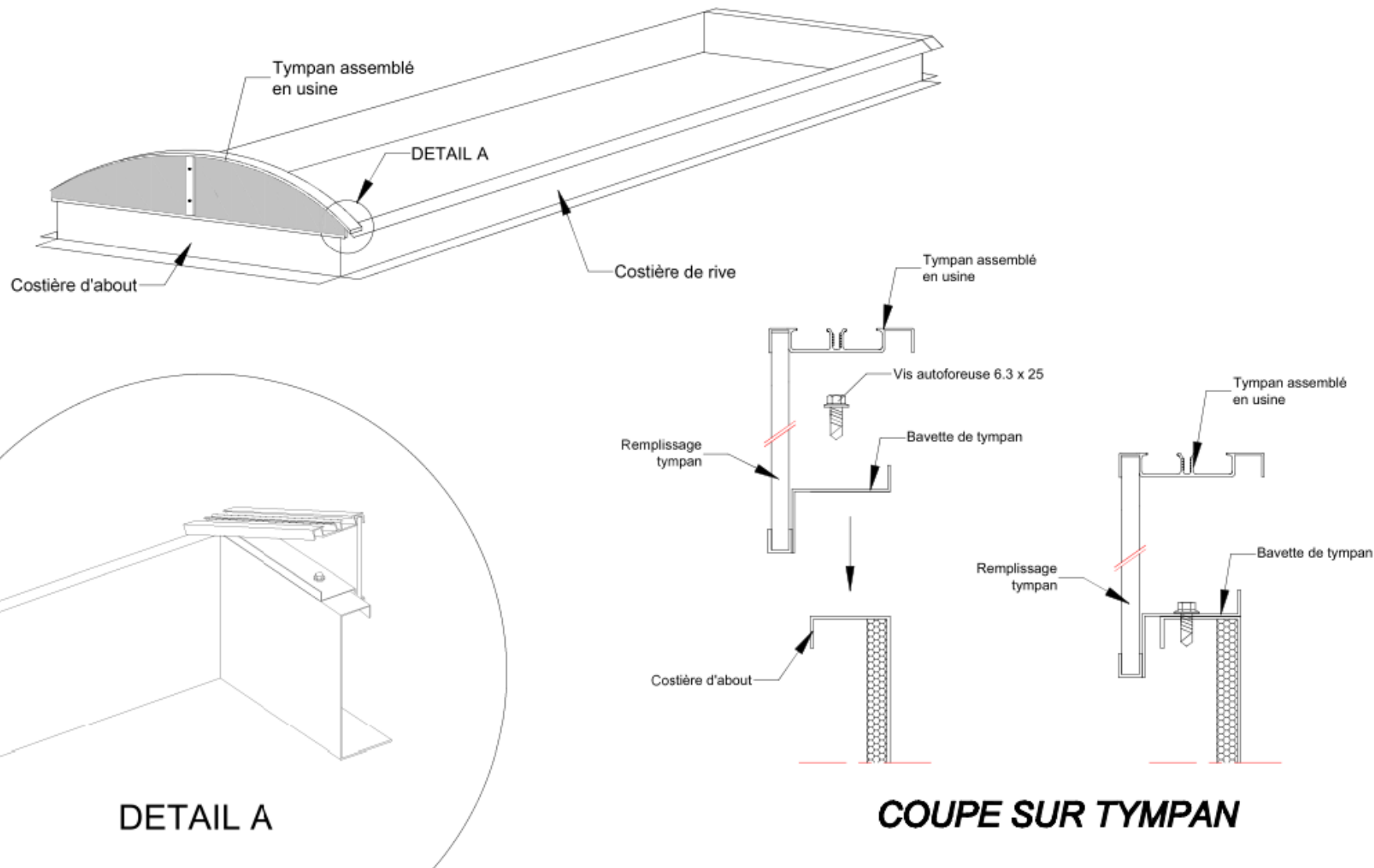



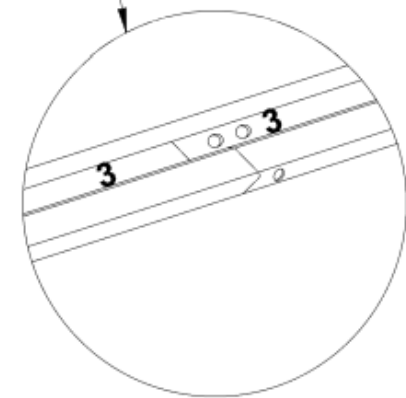
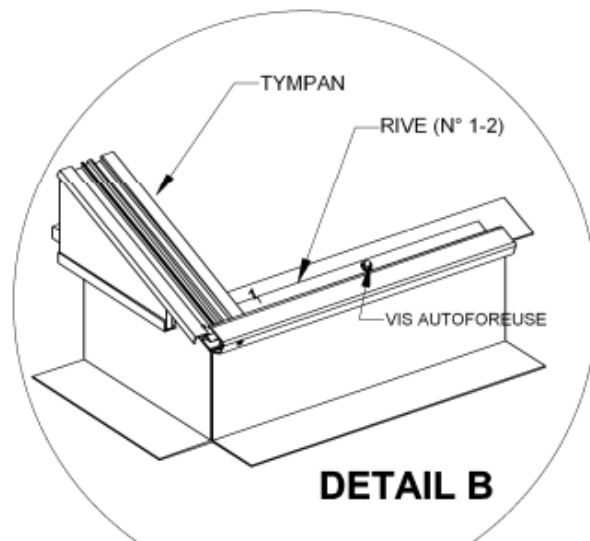
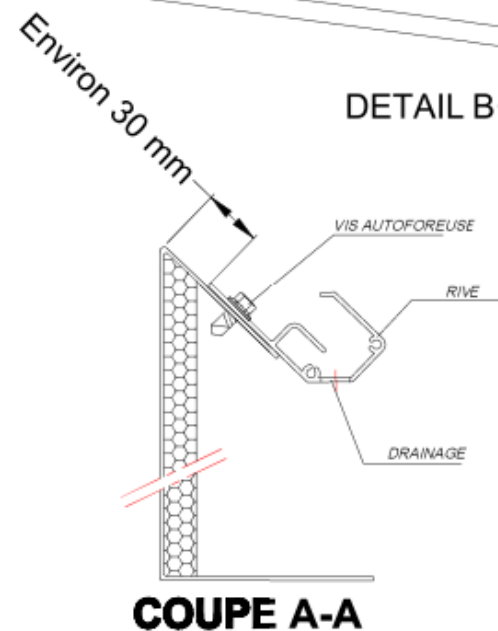
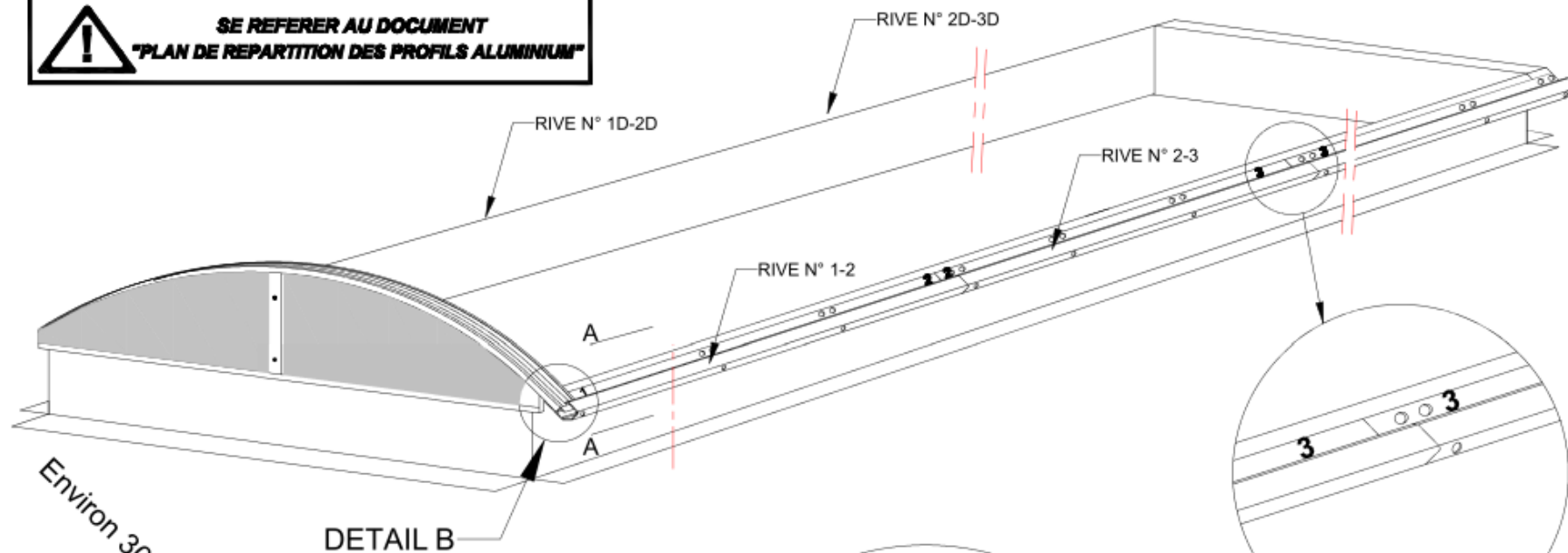

Profil de rive	
	AR10: PCA10
	AR16: PCA16
	ARGP16: PCA16 Grande Portée Corde > 4000

 **SE REFERER AU DOCUMENT  
"PLAN DE REPARTITION DES PROFILS ALUMINIUM"**

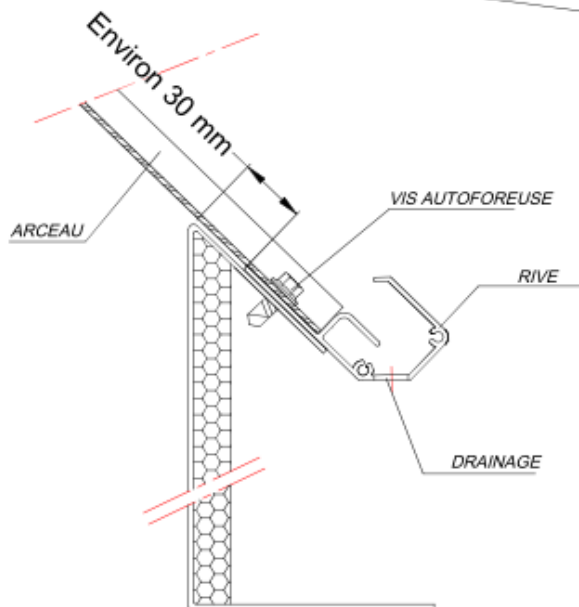
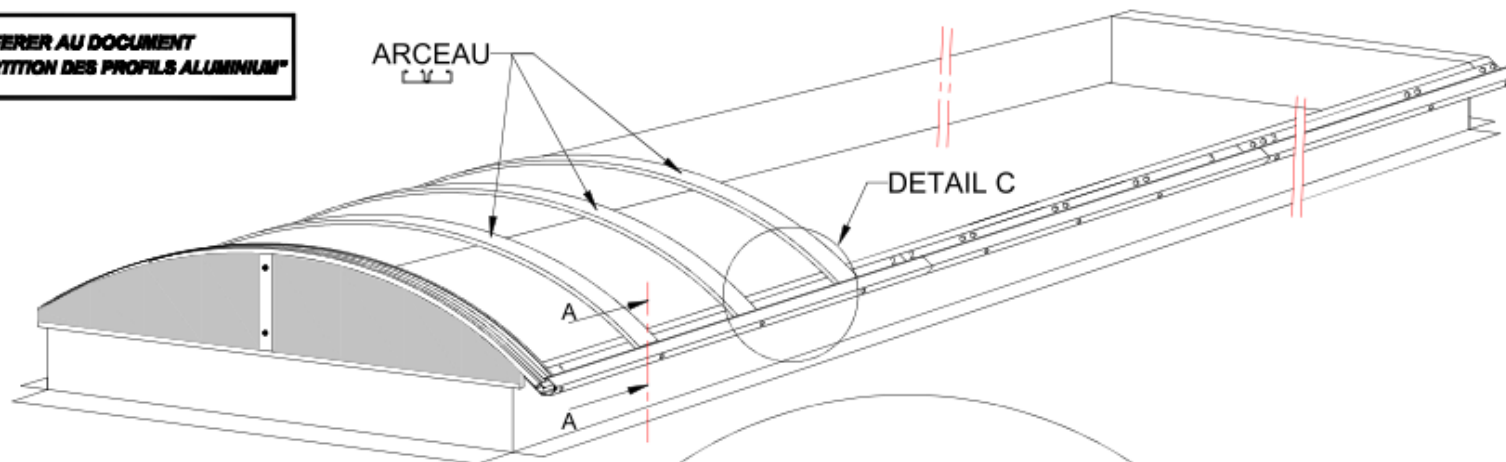

**COUPE A-A**

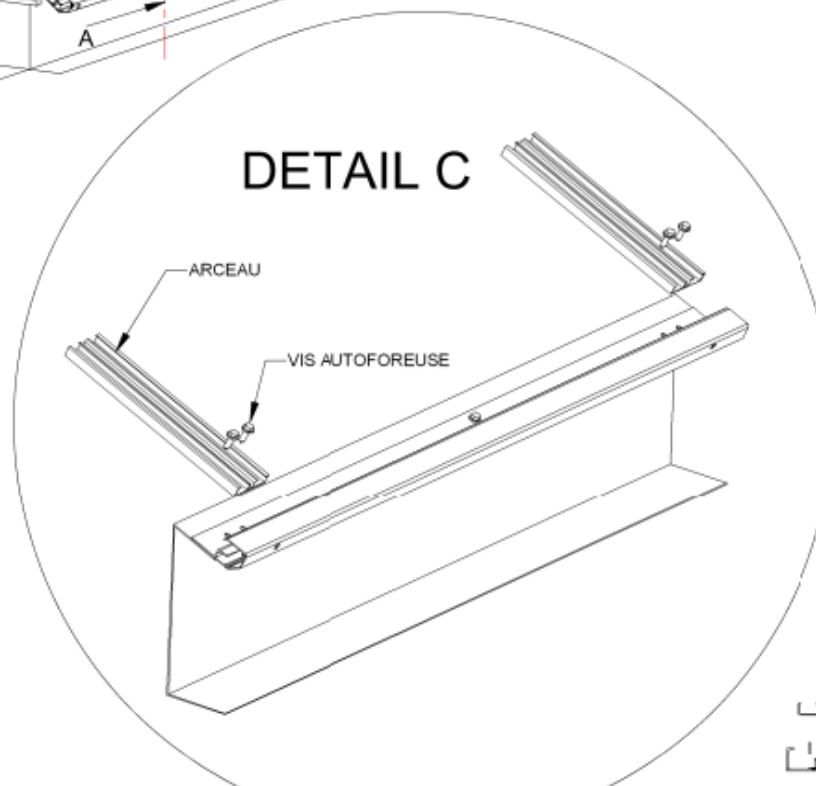

 API60

 API180: profil grande Portée

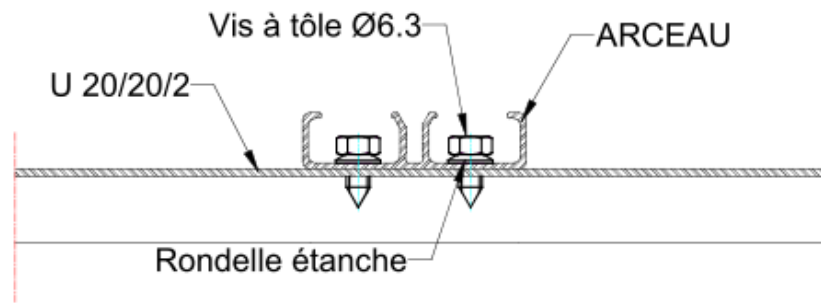
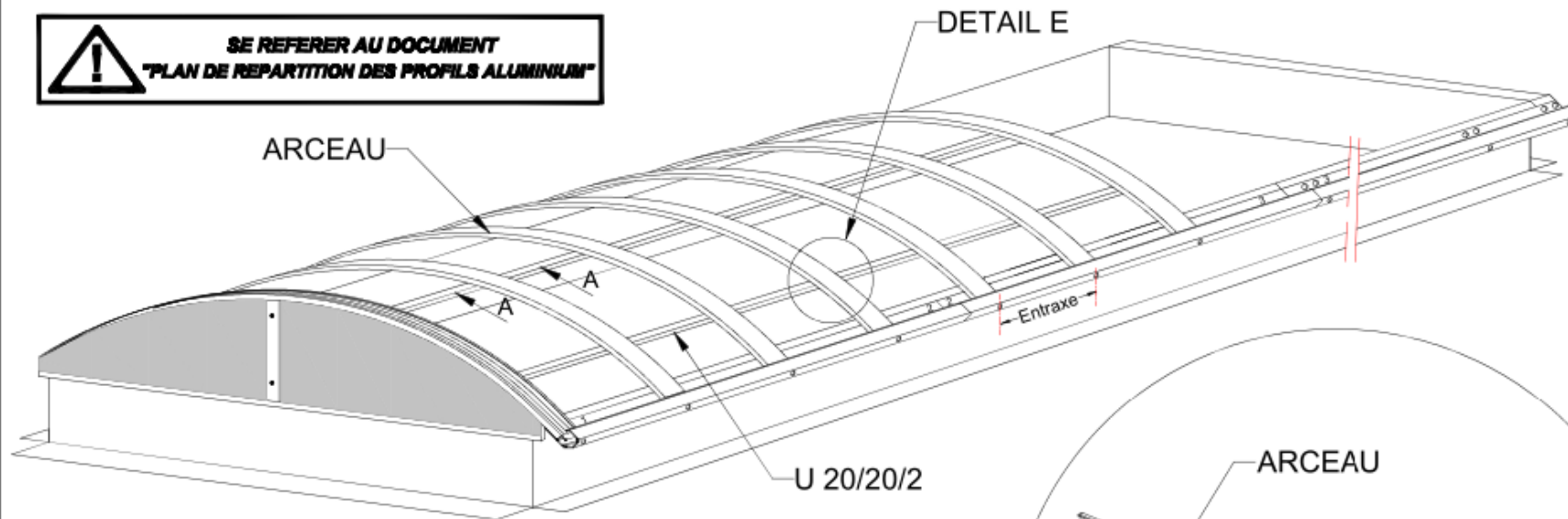

**COUPE A-A**

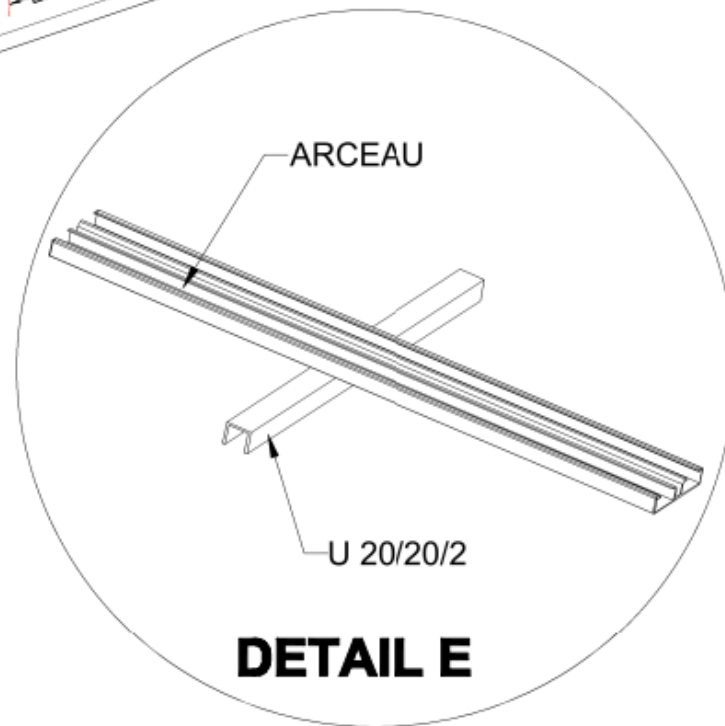

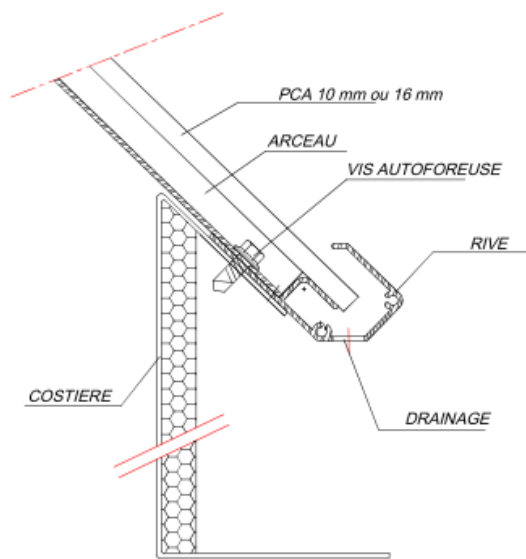
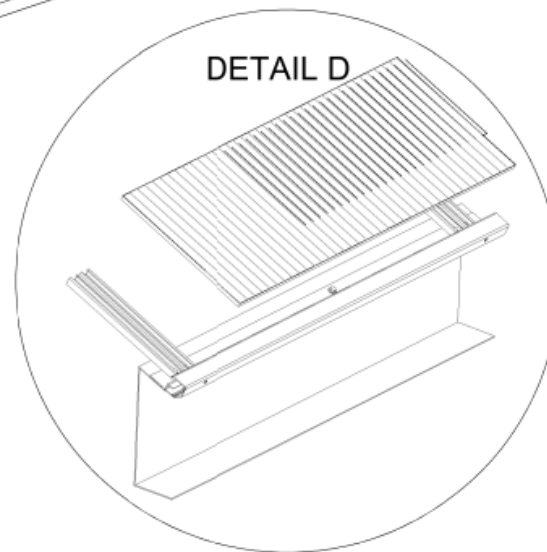
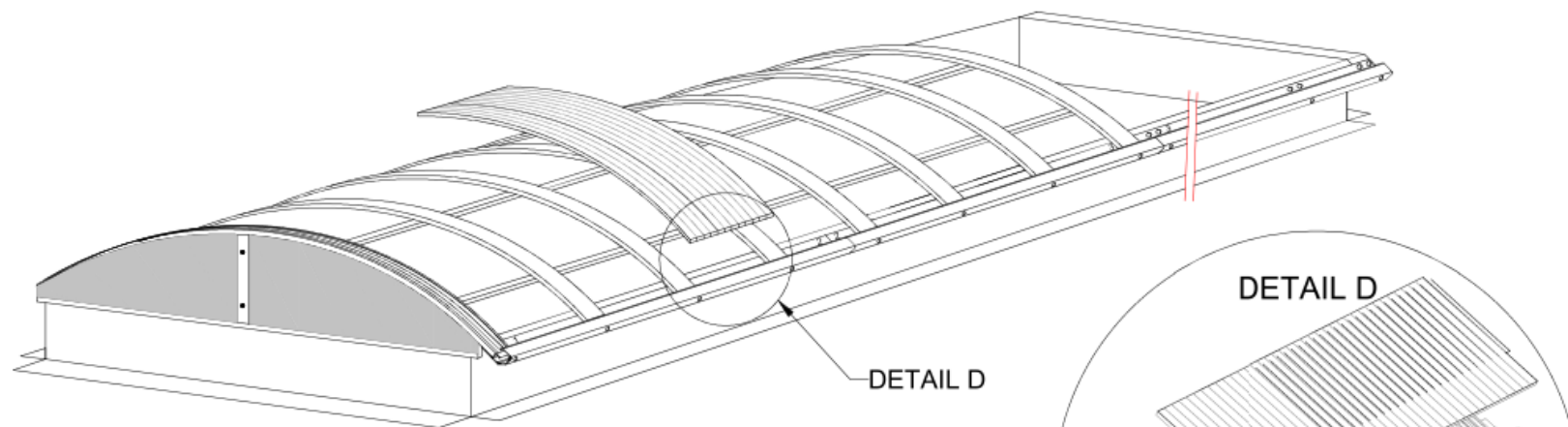

**COUPE SUR RIVE**

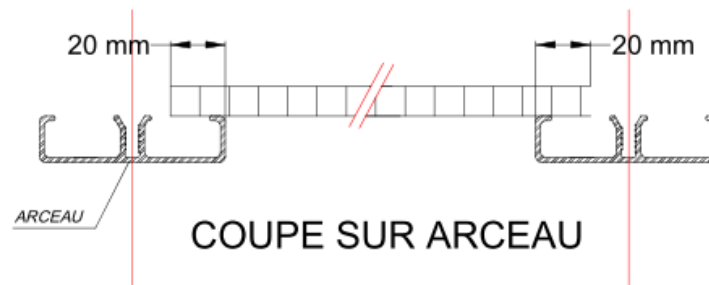

**COUPE SUR ARCEAU**

